

Reducing Tee Fig. 3205R



For Listings/Approval Details and Limitations, visit our website at www.asc-es.com or contact an ASC Engineered Solutions™ Sales Representative.

Material Specifications

Dimensions: ASME B16.3

Material: ASTM A536 Grade 65-45-12

Finish: Black

Threads: NPT per ASME B1.20.1

Agency Approvals: All ductile iron threaded fittings are UL/ULC Listed and FM Approved.

Note: Ductile iron fittings have higher tensile strength than that of steel pipe. Therefore, over tightening can cause damage to pipe threads which may cause leakage. Ductile iron fittings should be tightened approximately three turns beyond hand tight, but no more than four turns.

Figure 3205R Reducing Tee

Nominal Size	Maximum Working Pressure ▲	Dimensions			Approx Wt. Each
		A	B	C	
1 x 2 x 3 In. (mm)	psi (kPa)	In. (mm)	In. (mm)	In. (mm)	Lbs. (kg)
1 x ½ x 1 25 x 15 x 25	500 3450	1.50 38.10	1.36 34.54	1.50 38.10	0.64 0.29
1 x ¾ x 1 25 x 20 x 25	500 3450	1.50 38.10	1.45 36.83	1.50 38.10	0.73 0.33
1 x 1 x ½ 25 x 25 x 15	500 3450	1.26 32.00	1.26 32.00	1.36 34.54	0.71 0.32
1 x 1 x ¾ 25 x 25 x 20	500 3450	1.37 34.80	1.37 34.80	1.45 36.83	0.76 0.34
1 x 1 x 1¼* 25 x 25 x 32	500 3450	1.67 42.41	1.67 42.41	1.58 40.13	0.98 0.44
1 x 1 x 1½* 25 x 25 x 40	500 3450	1.80 45.72	1.80 45.72	1.65 41.91	1.16 0.53
1¼ x 1 x ½* 32 x 25 x 15	500 3450	1.34 34.04	1.26 32.00	1.53 38.86	0.82 0.37
1¼ x 1 x ¾ 32 x 25 x 20	500 3450	1.45 36.83	1.37 34.80	1.62 41.15	0.90 0.41
1¼ x 1 x 1 32 x 25 x 25	500 3450	1.58 40.13	1.50 38.10	1.67 42.42	1.00 0.45
1¼ x 1 x 1¼ 32 x 25 x 32	500 3450	1.75 44.45	1.67 42.42	1.75 44.45	1.08 0.49
1¼ x 1 x 1½ 32 x 25 x 40	500 3450	1.88 47.75	1.80 45.72	1.82 46.22	1.42 0.64
1¼ x 1¼ x ½ 32 x 32 x 15	500 3450	1.34 34.04	1.34 34.04	1.53 38.86	0.86 0.39

▲ - Working Pressure Ratings are for reference only and based on Sch. 40 pipe. For the latest UL/ULC, and FM pressure ratings versus pipe schedule, please visit asc-es.com or contact your local ASC Engineering Solutions™ Representative.

*Part supplied as "Bull Head Tee".

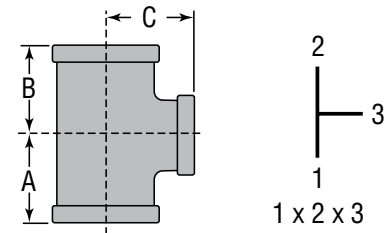

Figure 3205R Reducing Tee

Nominal Size	Maximum Working Pressure ▲	Dimensions			Approx Wt. Each
		A	B	C	
1 x 2 x 3 In. (mm)	psi (kPa)	In. (mm)	In. (mm)	In. (mm)	Lbs. (kg)
1¼ x 1¼ x ¾ 32 x 32 x 20	500 3450	1.45 36.83	1.45 36.83	1.62 41.15	0.92 0.42
1¼ x 1¼ x 1 32 x 32 x 25	500 3450	1.58 40.13	1.58 40.13	1.67 42.42	0.95 0.43
1¼ x 1¼ x 1½* 32 x 32 x 40	500 3450	1.88 47.75	1.88 47.75	1.82 46.22	1.45 0.66



PROJECT INFORMATION	APPROVAL STAMP
Project:	Approved
Address:	Approved as noted
Contractor:	Not approved
Engineer:	Remarks:
Submittal Date:	
Notes 1:	
Notes 2:	

Reducing Tee Fig. 3205R

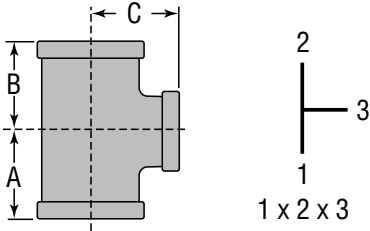

Figure 3205R Reducing Tee

Nominal Size	Maximum Working Pressure ▲	Dimensions			Approx Wt. Each
		A	B	C	
1 x 2 x 3					
In. (mm)	psi (kPa)	In. (mm)	In. (mm)	In. (mm)	Lbs. (kg)
1¼ x 1¼ x 2*	500 3450	2.10 53.34	2.10 53.34	1.90 48.26	1.75 0.79
1½ x 1 x ½	500 3450	1.41 35.81	1.34 34.04	1.66 42.16	0.95 0.43
1½ x 1 x ¾	500 3450	1.52 38.61	1.37 34.80	1.75 44.45	1.14 0.52
1½ x 1 x 1	500 3450	1.65 41.91	1.50 38.10	1.80 45.72	1.17 0.53
1½ x 1 x 1¼	500 3450	1.82 46.23	1.67 42.42	1.88 47.75	1.34 0.61
1½ x 1 x 1½	500 3450	1.94 49.28	1.80 45.72	1.94 49.28	1.45 0.66
1½ x 1¼ x ½	500 3450	1.41 35.81	1.34 34.04	1.66 42.16	1.05 0.48
1½ x 1¼ x ¾	500 3450	1.52 38.61	1.45 36.83	1.75 44.45	1.15 0.5
1½ x 1¼ x 1	500 3450	1.65 41.91	1.58 40.13	1.80 45.72	1.25 0.57
1½ x 1¼ x 2*	500 3450	2.16 54.86	2.10 53.34	2.02 51.30	1.90 0.86
1½ x 1½ x ½	500 3450	1.41 35.81	1.41 35.81	1.16 29.46	1.15 0.52
1½ x 1½ x ¾	500 3450	1.52 38.61	1.52 38.61	1.75 44.45	1.24 0.56
1½ x 1½ x 1	500 3450	1.65 41.91	1.65 41.91	1.80 45.72	1.30 0.59
1½ x 1½ x 1¼	500 3450	1.82 46.23	1.82 46.23	1.88 47.75	1.48 0.67

Figure 3205R Reducing Tee

Nominal Size	Maximum Working Pressure ▲	Dimensions			Approx Wt. Each
		A	B	C	
1 x 2 x 3					
In. (mm)	psi (kPa)	In. (mm)	In. (mm)	In. (mm)	Lbs. (kg)
1½ x 1½ x 2*	500 3450	2.16 54.86	2.16 54.86	2.02 51.30	1.98 0.90
2 x 1 x 2	500 3450	2.25 57.15	2.02 51.31	2.25 57.15	2.15 0.98
2 x 1¼ x 2	500 3450	2.25 57.15	2.10 53.34	2.25 57.15	2.30 1.04
2 x 1½ x ½	500 3450	1.49 37.85	1.41 35.81	1.88 47.75	1.50 0.68
2 x 1½ x ¾	500 3450	1.60 40.64	1.52 38.61	1.97 50.04	1.62 0.73
2 x 1½ x 1	500 3450	1.73 43.94	1.65 41.91	2.02 51.31	1.64 0.74
2 x 1½ x 1¼	500 3450	1.90 48.26	1.82 46.23	2.10 53.34	1.80 0.82
2 x 1½ x 1½	500 3450	2.02 51.31	1.94 49.28	2.16 54.86	2.00 0.91
2 x 1½ x 2	500 3450	2.25 57.15	2.16 54.86	2.25 57.15	2.35 1.07
2 x 2 x ½	500 3450	1.49 37.85	1.49 37.85	1.88 47.75	1.60 0.73
2 x 2 x ¾	500 3450	1.60 40.64	1.60 40.64	1.97 50.04	1.68 0.76
2 x 2 x 1	500 3450	1.73 43.94	1.73 43.94	2.02 51.31	1.85 0.84
2 x 2 x 1¼	500 3450	1.90 48.26	1.90 48.26	2.10 53.34	2.04 0.93
2 x 2 x 1½	500 3450	2.02 51.31	2.02 51.31	2.16 54.86	2.18 0.99

▲ – Working Pressure Ratings are for reference only and based on Sch. 40 pipe. For the latest UL/ULC, and FM pressure ratings versus pipe schedule, please visit asc-es.com or contact your local ASC Engineering Solutions™ Representative.

*Part supplied as "Bull Head Tee".