

#### Features

**Low current, 24 VDC electronic mini-horn provides the following features:**

- Operation with Simplex SmartSync two-wire horn or strobe control
- Small profile horn packaged in a rugged, high impact, flame retardant thermoplastic housing, available in red or white
- Snap-on cover presents a clean and neat appearance. Removal of the snap-on cover requires a tool.
- Convenient mounting to a single gang electrical box, flush or surface mounted

**SmartSync two-wire control of audible and visible notification appliance provides the following functions:**

- Control of mini-horn tone as Temporal Pattern, March Time pattern, or on continuously; controlled separately from visible appliances on the same circuit
- Visible appliances on the same SmartSync circuit operate at a synchronized 1 Hz flash rate
- Operation that allows **On until silenced** and **On until reset** on the same two-wire pair

#### Listing reference

UL Listed to Standard 464

ULC Listed to Standard S525

#### Description

Mini-horns provide a loud and penetrating notification sound controlled by SmartSync two-wire operation. The compact package allows mounting in a variety of convenient locations. An output level switch allows selection of low or high sound output as required for the location. See specifications for details.

SmartSync operation mode uses a two-wire circuit to activate the horn and strobe on the same Notification Appliance Circuit (NAC) and then the horn can be silenced while the strobe remains flashing. The horn operates as **On until silenced** while the strobe operation is **On until reset**.

SmartSync two-wire control is available for the following models:

- 4006, 4007ES Hybrid, 4008, 4010, 4010ES, 4100ES, and 4100U Fire Alarm Control Units (FACUs). Refer to individual product data sheets for more information.
- 4009 IDNet NAC Extenders. Refer to the *4009 IDNet NAC Extender for Control with IDNet Communications or Conventional NACs S4009-002* data sheet.
- SmartSync Control Module (SCM) Model 4905-9938. Refer to the *SmartSync Control Module and Strobe Synchronization Modules S4905-003* data sheet.



Figure 1: Front and side view of the red mini-horn

#### Product selection

Table 1: Product selection

Model	Description
4901-9858	Red mini-horn
4901-9859	White mini-horn

#### Specifications

Table 2: Specifications

Specification	Description
Rated voltage range	16 VDC to 33 VDC
Current rating	19 mA maximum
Dimensions	4 1/2 in. H x 2 3/4 in. W x 1 1/4 in. D or 114 mm x 69 mm x 32 mm
Temperature range	32°F to 122°F or 0°C to 50°C
Humidity range	10% to 93%, non-condensing at 100°F or 38°C
Connections	Terminal blocks for 18 AWG to 12 AWG or 0.82 mm <sup>2</sup> to 3.31 mm <sup>2</sup> ; two wires per terminal for in or out wiring

Table 3: Sound output ratings

Sound Level Test	Output Level Selection	
	High	Low
Reverberant chamber test, per UL 464 at 10 ft or ~3 m	79 dBA	68 dBA
Anechoic chamber test, for each ULC S525 at 3 m or ~10 ft	93 dBA	82 dBA
Polar dispersion reference for each ULC S525	-3 dBA at ± 40° off-axis -6 dBA at ± 85° off-axis	

**Note:** UL output ratings below 75 dBA are for NFPA 72 Private Mode applications. ULC output ratings below 85 dBA are for use in applications for each applicable local codes.

\* This product has been approved by the California State Fire Marshal (CSFM) pursuant to Section 13144.1 of the California Health and Safety Code. See CSFM Listing 7135-0026:334 for allowable values and/or conditions concerning material presented in this document. Additional listings may be applicable; contact your local product supplier for the latest status.

**Installation reference**

For additional information, refer to *4901 TrueAlert Non-Addressable Mini-Horn Installation Instructions 579-870*.

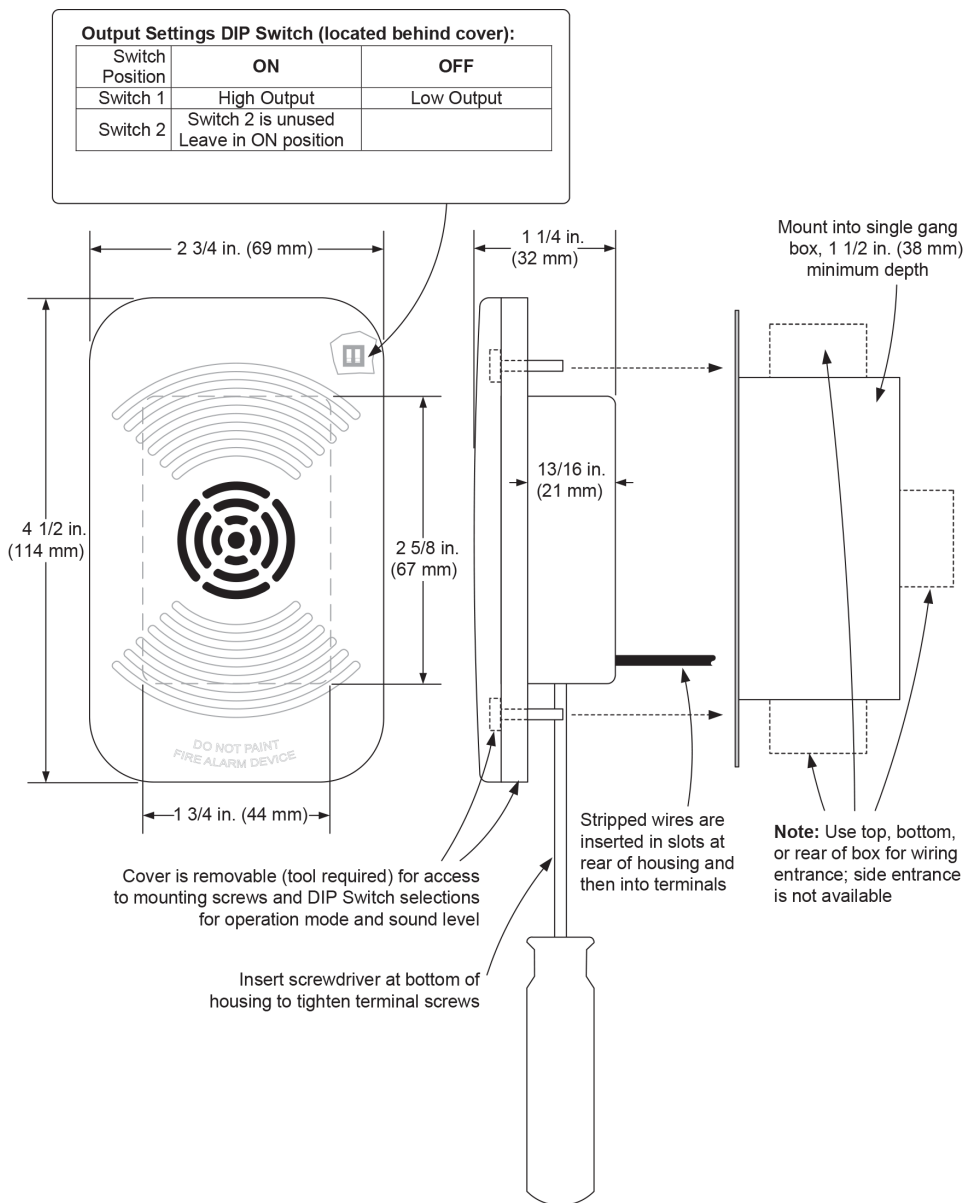

**Figure 2: Installation reference**