

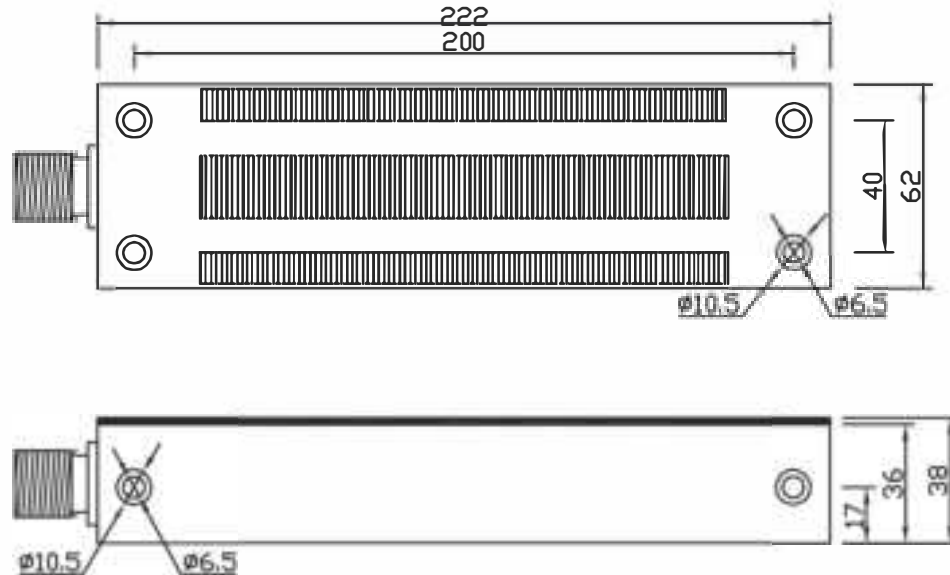

FAS-OUT 1200 Waterproof Outdoor Magnetic Lock

User's Manual

Magnetic lock dimension drawing



Adsorption board size chart

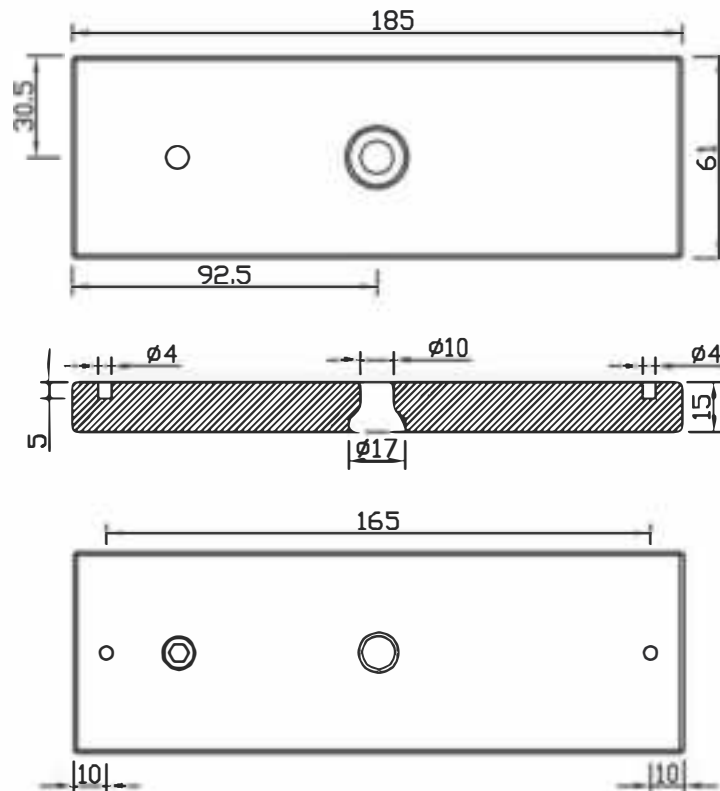

Operating Voltage:	DC12V	DC24V
Operating Current:	500mA	250mA

A.12VDC Input:

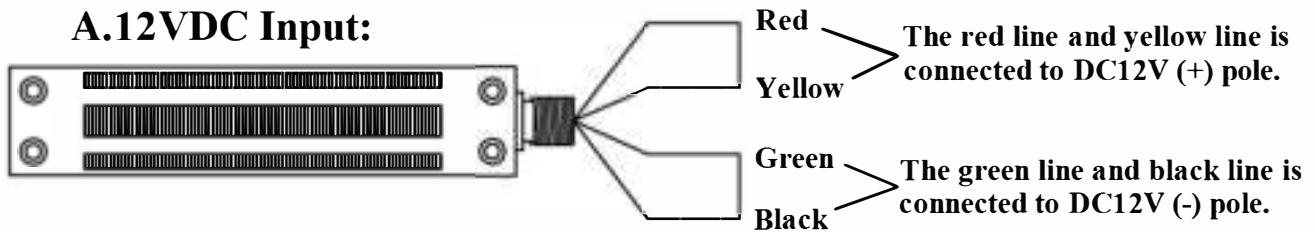

B.24VDC Input:

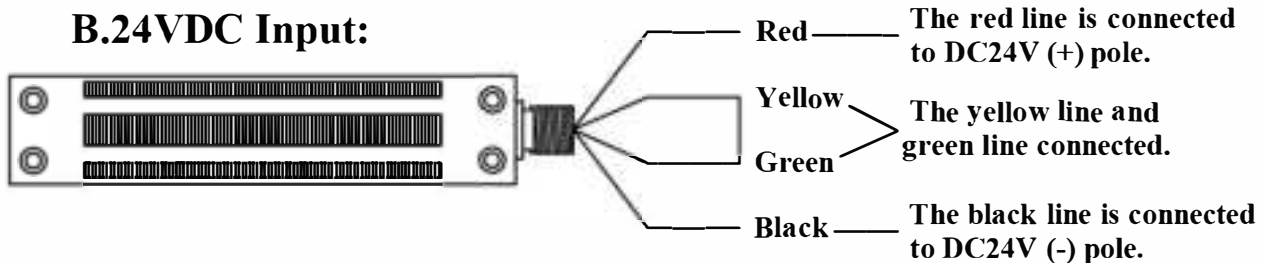

C. Connection method of backflow prevention diode:

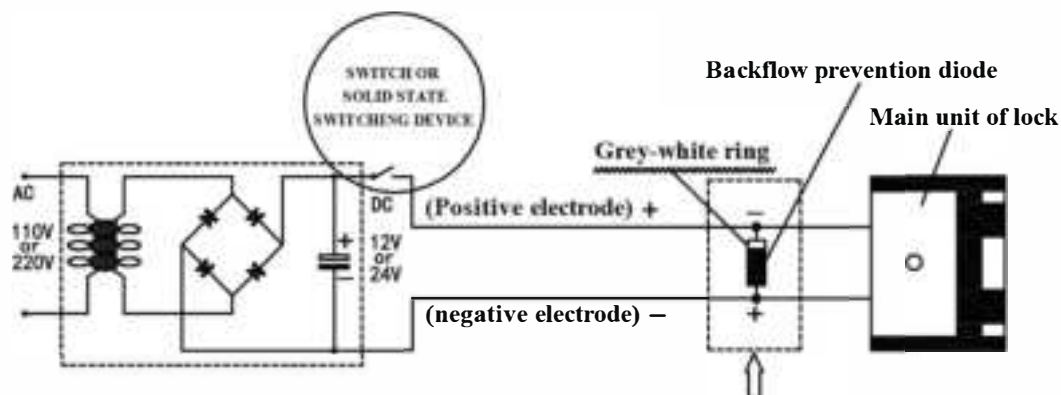

Connection method of backflow prevention diode:

- Connect the negative electrode of diode with the positive electrode of lock body.
- Connect the positive electrode of diode with the negative electrode of lock body.