

HTP & HT Series Transformers

Description

The HTP Series plug-in AC transformers come in several sizes, the largest with an output rating of 50 VA. They have a case mounting tab to keep them secured to the wall outlet, and screw terminals for power lead wires. The open-frame HT Series AC transformers come in two sizes and provide lead wires for connections, with a maximum output of 175 VA.

Both series of transformers have built-in thermal protection and are UL-Recognized, Class 2. They are used in a wide range of applications in CCTV, access, and security systems — supplying low-voltage AC.

Benefits

- Size options for your particular application.
- Appropriate accessories available for products' best performance.
- Plug in units mount to standard wall outlet allowing quick and easy installation.
- Wall plug in units have case tab to secure transformer to outlet.
- Ground pin on select wall plug in units for added safety.
- All models have thermal protection built in to limit damage from circuit overloads.

Specifications

- Built-in thermal protection.
- UL Recognized, Class 2.
- Operating temperature range: -4°F to +95°F (-20°C to +35°C), indoor use only.
- HTP Series mounts to a standard wall outlet with a screw-down tab.
- HT Series mounts using screw holes in mounting feet.
- **HP2412IL8** is an in-line unit with flying leads.

Listings

Listings and approvals below apply to the basic HPTV2404UL power supply. In some cases, certain modules may not be listed by certain approval agencies, or listing may be in process. Consult factory for latest listing status.

UL Listed File: E231217.



HTP Series Plug-In Transformers	
HTP1220	12 VAC, 20 VA; Class 2 plug-in with thermal cut-out.
HTP1620	16 VAC, 20 VA; Class 2 plug-in with thermal cut-out.
HTP1640	16 VAC, 40 VA; Class 2 plug-in with thermal cut-out.
HPT1850	18 VAC, 50 VA; Class 2 plug-in with thermal cut-out.
HTP2420	24 VAC, 20 VA; Class 2 plug-in with thermal cut-out.
HTP2440	24 VAC, 40 VA; Class 2 plug-in with thermal cut-out.
HTP2450	24 VAC, 50VA; Class 2 plug-in with thermal cut-out.
HT Series Open-Frame Transformers	
HT24100	24 VAC, 100 VA, current 4.0 A; Class 2 open-frame with thermal cut-out.
HT24200*	24 VAC, 200 VA, current 8.0 A; Open-frame with thermal cut-out.
HT28100	28 VAC, 100 VA, current 3.57 A; Class 2 open-frame with thermal cut-out.
HT28175*	28 VAC, 175 VA, current 6.25 A; Open-frame with thermal cut-out.
AC to DC Converters	
HP2412IL8*	24 VAC in, 12 VDC/800 mA out converter, PTC limited.
*Not UL Recognized	

Model	HT Mechanical Dimensions (cm)						Lbs (kg)
	A	B	C	D	E	F	
HT24100	3.09" (7.85)	2.70" (6.86)	2.75" (6.99)	1.40" (3.56)	3.09" (7.85)	3.55" (9.02)	2.8 (1.27)
HT24200	3.77" (9.58)	3.62" (9.19)	3.62" (9.19)	1.50" (3.81)	3.78" (9.60)	3.00" (7.62)	5.3 (2.40)
HT28100	3.09" (7.85)	2.70" (6.86)	2.75" (6.99)	1.40" (3.56)	3.09" (7.85)	3.55" (9.02)	2.8 (1.27)
HT28175	3.77" (9.58)	3.62" (9.19)	3.62" (9.19)	1.50" (3.81)	3.78" (9.60)	3.00" (7.62)	5.3 (2.40)

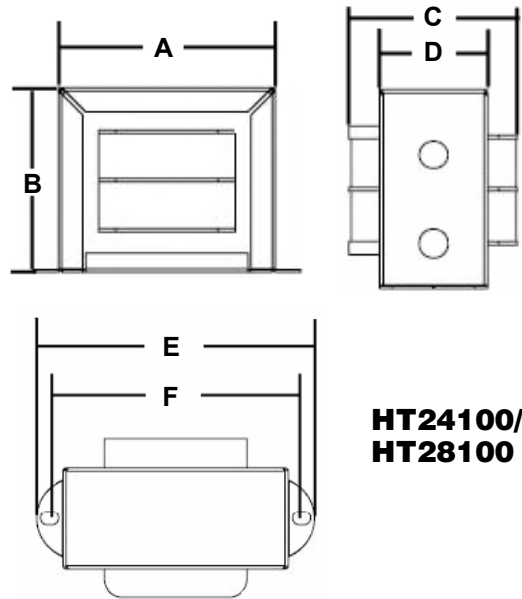

**HT24100/
HT28100**

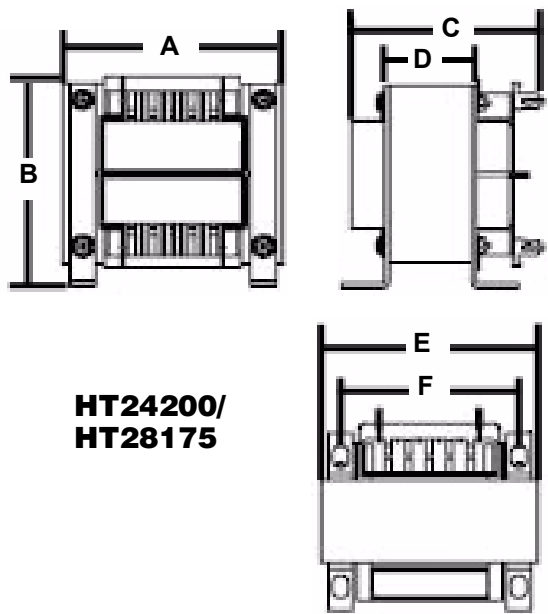

**HT24200/
HT28175**

This document is not intended to be used for installation purposes. We try to keep our product information up-to-date and accurate. We cannot cover all specific applications or anticipate all requirements. All specifications are subject to change without notice.
 ©2010 by Honeywell International Inc. All rights reserved. Unauthorized use of this document is strictly prohibited.

Automation and Control Solutions

Honeywell
 12 Clintonville Road
 Northford, CT 06472-1610
 www.honeywellpower.com

1(877) HPP-POWER
 hpp_techserv@honeywell.com

DH-1005:A
 May 2010
 Made in the U.S.A.
 © U.S. Registered Trademark
 © 2010 Honeywell International Inc.
 Page 2 of 2

