

CURRENT TRANSFORMER

CTS-100A55-333

Enclosed Self-Powered Solid Core 100 Amp Revenue Grade Current Transformers with 333 mV Output

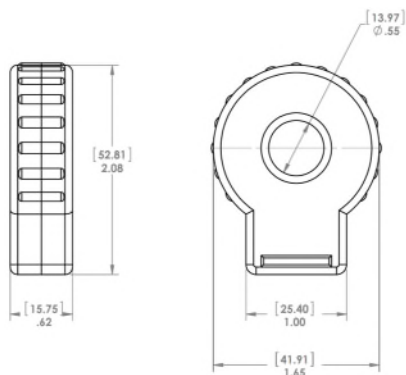

SPECIFICATIONS

Environment: Indoor Use Only
5 to 176° F (-15 to 80°C)
90% relative humidity

Wires: 6', 22 AWG
600V Rated

Phase Direction: Arrow points toward Load

Primary Input (A): 100A

Secondary Output (V): 0.333 Vac

Accuracy: 0.2% (typical)

Linearity: 10%-120%

Polarity: White-Hi, Black-Low

Frequency Range: 40-400 Hz

Max Sense Voltage: 600 Vac

Approvals: ETL Listed, CE, RoHS

Ratio: 100A/0.333V