

## Genesis LED EG4 Series Wall Notification Appliance Installation Sheet

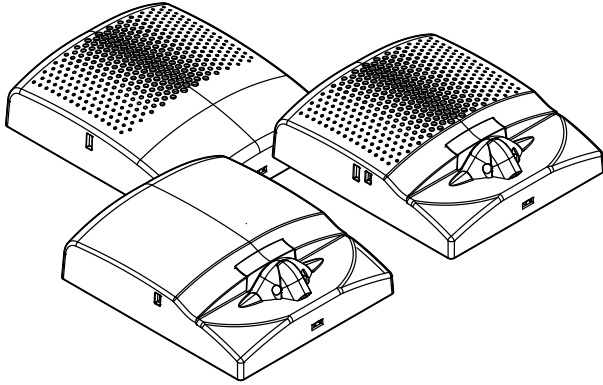

### Description

Genesis LED EG4A horns, EG4V strobes, and EG4VA horn-strobes are wall-mounted plug-in fire alarm notification appliances designed for indoor dry applications. See Table 1 to Table 3 for a list of models.

**Table 1: EG4A horn models**

Catalog number	Description
EG4ARF	Wall horn, red, FIRE
EG4ARN	Wall horn, red, no marking
EG4AWF	Wall horn, white, FIRE
EG4AWN	Wall horn, white, no marking

**Table 2: EG4V strobe models**

Catalog number	Description
EG4VRF	Wall strobe, red, FIRE
EG4VRN	Wall strobe, red, no marking
EG4VWF	Wall strobe, white, FIRE
EG4VWN	Wall strobe, white, no marking

**Table 3: EG4AV horn-strobe models**

Catalog number	Description
EG4AVRF	Wall horn-strobe, red, FIRE
EG4AVRN	Wall horn-strobe, red, no marking
EG4AVWF	Wall horn-strobe, white, FIRE
EG4AVWN	Wall horn-strobe, white, no marking

Genesis LED EG4 Series notification appliances feature:

- Field-configurable horn and strobe outputs. See Figure 2.
- Enhanced synchronization circuitry to comply with the latest requirements of UL 1638 and CAN/ULC-S526.
- Input wiring test points on the front of the appliance when the cover is removed.

**Note:** Synchronized operation requires a separately installed synchronization device. See the control unit or power supply compatibility list for compatible synchronization devices.

### Configuration

**Caution:** Equipment damage hazard. Using excessive force when removing the appliance cover may damage the cover and prevent it from latching in place.

**To configure the notification appliance:**

1. Remove the appliance cover. See Figure 1.  
Insert a small, flat-bladed screwdriver into the slot at the bottom of the appliance.  
Gently pull up on the screwdriver to pry the bottom of the appliance cover down and away from the appliance.  
Lift the bottom of the cover out and over the top of the appliance.
2. On horns and horn-strobes, set the sound output switch for the required value. See Figure 2.
3. On strobes and horn-strobes, set the light output for the required value. See Figure 2.
4. Replace the appliance cover.

**Figure 1: Removing and replacing the cover**

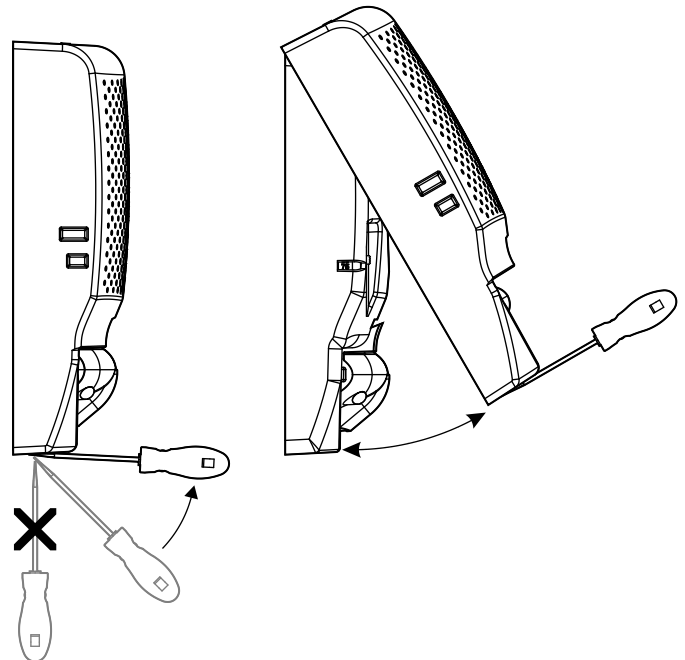

**Figure 2: Light and sound output settings**

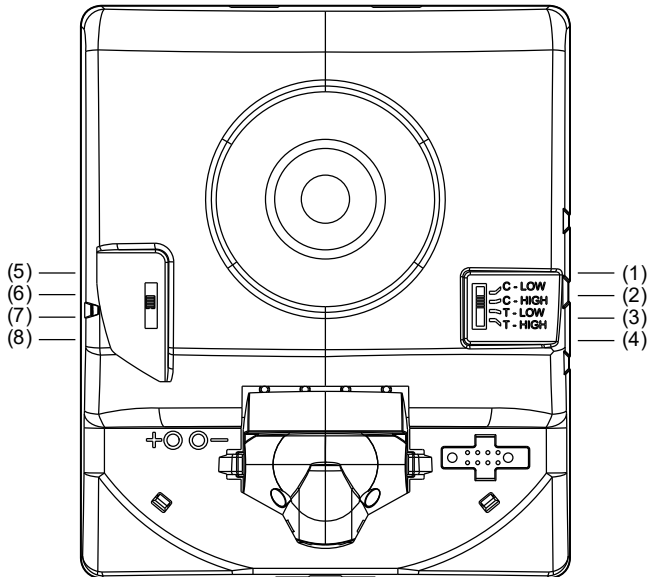

- |                          |                 |
|--------------------------|-----------------|
| (1) Constant, low dB     | (5) 110 candela |
| (2) Constant, high dB    | (6) 75 candela  |
| (3) T3 temporal, low dB  | (7) 30 candela  |
| (4) T3 temporal, high dB | (8) 15 candela  |

**Note:** Temporal 3 coding is the required output for fire notification devices per NFPA 72. Any device coding other than Temporal 3 is at the discretion and approval of the local authority having jurisdiction (AHJ).

### Installation

Install and wire this device in accordance with applicable national and local codes, ordinances, and regulations.

**Caution:** Electrical supervision requires that you break the wire run at each terminal. Do not loop the notification circuit field wires around the terminals.

#### To install the appliance:

- Using the screws supplied with the wiring plate, attach the wiring plate and, if used, the trim plate to the electrical box. See Figure 3 and Figure 4. Do not overtighten the screws.

The trim plate is ordered separately.

- Connect the field wiring. Observe signal polarity for the appliance to operate properly. See Figure 5.
- Remove the shorting clip (Figure 3, item 6). Retain for future use.
- Plug the appliance into the wiring plate by setting the appliance on the top of the wiring plate, and then snapping the bottom into place. See Figure 6.

To unplug the appliance, press the spring clip on the bottom, and then lift the appliance away from the wiring plate.

- Test the unit for proper operation.

**Figure 3: Typical electrical box mounting**

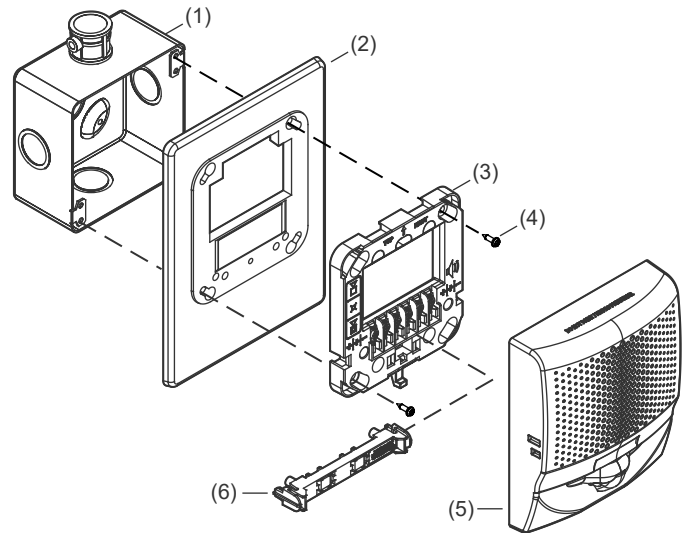

- Electrical box
- Trim plate (optional)
- Wiring plate (required)
- Machine screw (2X, supplied with wiring plate)
- Notification appliance
- Shorting clip

**Figure 4: Typical surface box mounting**

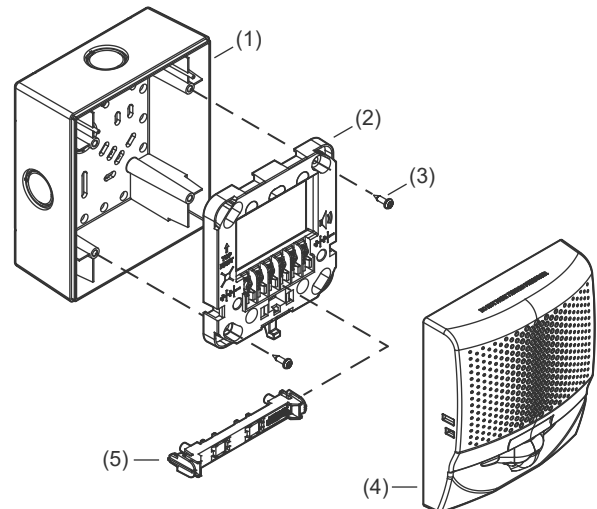

- Surface box
- Wiring plate (required)
- Plastite screw (2X, supplied with surface mount box)
- Notification appliance
- Shorting clip

Figure 5: Wiring

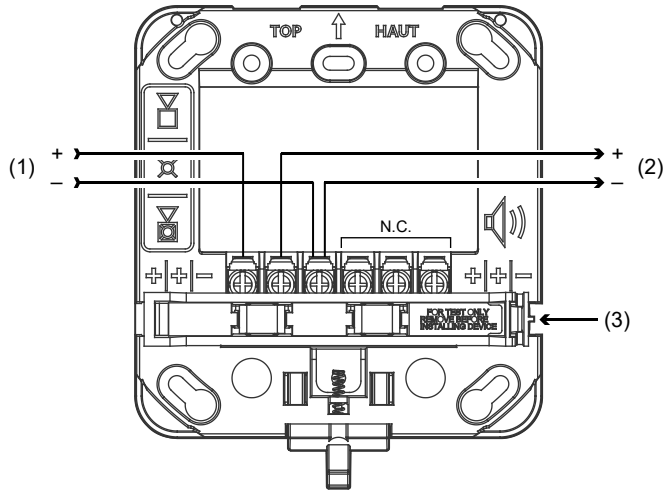

- (1) Horn/strobe circuit in (signal polarity shown in the active condition)
- (2) Horn/strobe circuit out
- (3) Shorting clip

**Note:** To maintain circuit continuity, do not remove the shorting clip (Figure 5, item 3) until you are ready to install the notification appliance.

Figure 6: Removing and replacing the appliance

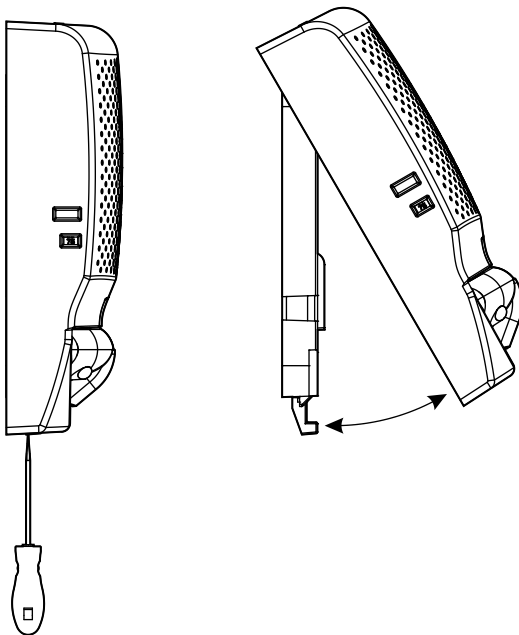

## Maintenance and testing

**Caution:** Equipment damage hazard. To maintain the required agency listings, do not change factory-applied finishes.

This unit is not serviceable or repairable. If the unit fails to operate, contact the supplier for a replacement.

Perform a visual and operational inspection in accordance with applicable codes and standards or as directed by the local authority having jurisdiction.

Input wiring test points are available on the front of the appliance when the cover is removed. The test points let you easily spot check the field circuit wiring without the need to remove the appliance from the wall. See Figure 7.

Figure 7: Test points

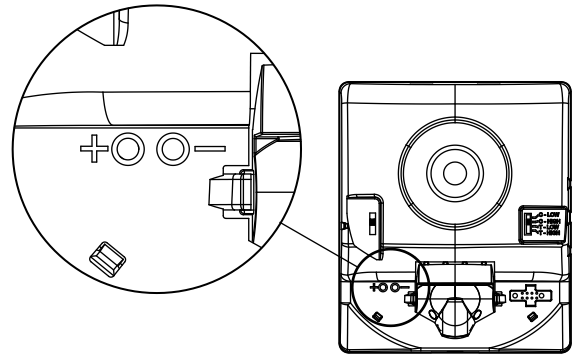

**Note:** Marking indicates signal polarity when the circuit is active.

## Specifications

Operating voltage	16 to 33 VDC, 16 to 33 VFWR	
Operating current	See Table 4 to Table 6	
Horn signal type	Constant or temporal (TC3)	
Sound output	See Table 7	
Sound pattern	See Table 8	
Light output	15, 30, 75, or 110 cd	
Strobe flash rate	1 fps (flash per second) approx.	
Light distribution	See Figure 8	
Synchronization	20 $\Omega$ max. between any two devices. To determine allowed wire resistance, refer to these specifications, and the specifications for the synchronized signal source.	
Dimensions	See Figure 9	
Strobe-to-box center offset	-2.50 in. (-6.35 cm)	
Compatible electrical boxes	1-gang, 2-gang, 4-inch square, 4-inch octagon with GOCT adapter plate, EG4RSB, EG4WSB	
Wiring plate	GRSW	
Wire size	12 to 18 AWG (0.75 to 2.50 mm <sup>2</sup> )	
Screw torque		
Mounting screws	10 lbf-in (1.2 N-m) max.	
Terminal screws	12 lbf-in (1.4 N-m) max.	
Trim plates	EG4TR, EG4TW	
Replacement covers	See Table 9 to Table 11	
Operating environment		
Temperature	32 to 122°F (0 to 50°C)	
Relative humidity	0 to 93% noncondensing	
Storage temperature	-40 to 158°F (-40 to 70°C)	

Table 4: Operating current (horn models)

Sound setting	16 to 33 VDC	16 to 33 VFWR
C-LOW, T-LOW	18 mA	22 mA
C-HIGH, T-HIGH	28 mA	38 mA

Table 5: Operating current (strobe models)

Strobe setting	16 to 33 VDC	16 to 33 VFWR
15, 30, 75, 110	28 mA	36 mA

**Table 6: Operating current (horn-strobe models)**

Strobe setting	Sound setting	16 to 33 VDC	16 to 33 VFWR
15, 30, 75, 110	C-LOW, T-LOW	40 mA	48 mA
	C-HIGH, T-HIGH	50 mA	65 mA

**Table 7: Sound output (horn and horn-strobe models)**

Sound setting	Reverberant (UL 464)	Anechoic (CAN/ULC-S525)
C-LOW, T-LOW	80 dBA	86 dBA
C-HIGH, T-HIGH	86 dBA	92 dBA

**Table 8: Sound pattern (ULC)**

Axis	Angle	Change in output
Horizontal	135° and 45°	-3 dBA
	150° and 30°	-6 dBA
Vertical	135° and 40°	-3 dBA
	150° and 30°	-6 dBA

**Table 9: EG4A horn replacement covers**

Catalog number	Description
EG4ARF-CVR	Cover, wall horn, red, FIRE
EG4ARN-CVR	Cover, wall horn, red, no marking
EG4AWA-CVR	Cover, wall horn, white, ALERT
EG4AWF-CVR	Cover, wall horn, white, FIRE
EG4AWN-CVR	Cover, wall horn, white, no marking

**Table 10: EG4V strobe replacement covers**

Catalog number	Description
EG4VRF-CVR	Cover, wall strobe, red, FIRE
EG4VRN-CVR	Cover, wall strobe, red, no marking
EG4VWA-CVR	Cover, wall strobe, white, ALERT
EG4VWF-CVR	Cover, wall strobe, white, FIRE
EG4VWN-CVR	Cover, wall strobe, white, no marking

**Table 11: EG4AV horn-strobe replacement covers**

Catalog number	Description
EG4AVRF-CVR	Cover, wall horn-strobe, red, FIRE
EG4AVRN-CVR	Cover, wall horn-strobe, red, no marking
EG4AVWA-CVR	Cover, wall horn-strobe, white, ALERT
EG4AVWF-CVR	Cover, wall horn-strobe, white, FIRE
EG4AVWN-CVR	Cover, wall horn-strobe, white, no marking

**Contact information**

For contact information, see [www.kidde-esfire.com](http://www.kidde-esfire.com).

**Figure 8: 110 cd light distribution**

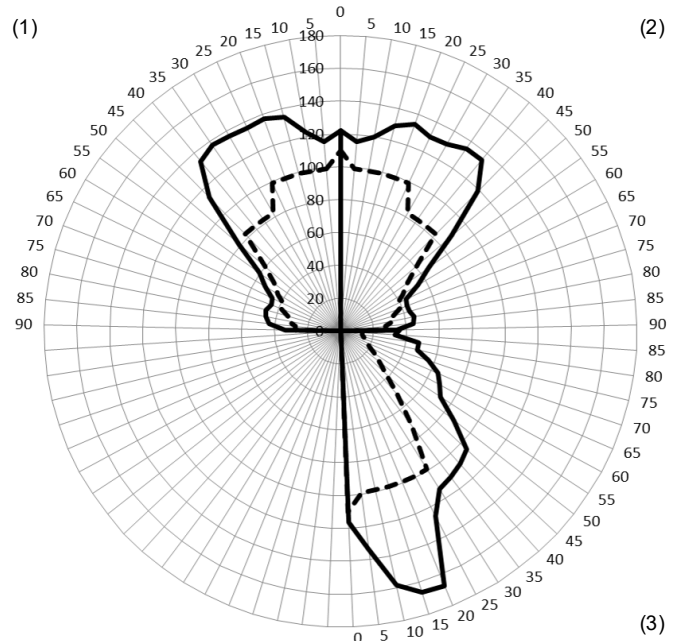

- (1) Horizontal left
  - (2) Horizontal right
  - (3) Vertical bottom
- Measured  
 UL minimum

**Figure 9: Dimensions**

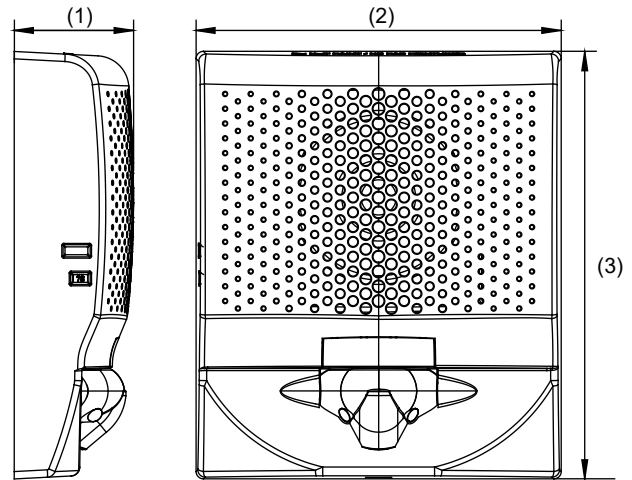

- (1) 1.62 in. (4.11 cm)
- (2) 4.95 in. (12.57 cm)
- (3) 5.78 in. (14.68 cm)

**Regulatory information**

UL rating	Regulated 24 DC and 24 FWR
FCC compliance	This device complies with part 15 of the FCC Rules. Operation is subject to the following two conditions: (1) This device may not cause harmful interference, and (2) this device must accept any interference received, including interference that may cause undesired operation.
Industry Canada compliance	This Class A digital apparatus complies with Canadian ICES-003.
Environmental class	Indoor, dry